

MODEL RV

PILOT OPERATED RELIEF VALVE

RV1 VALVE INCLUDES
1R0001 CARTRIDGE
(OPTIONAL)

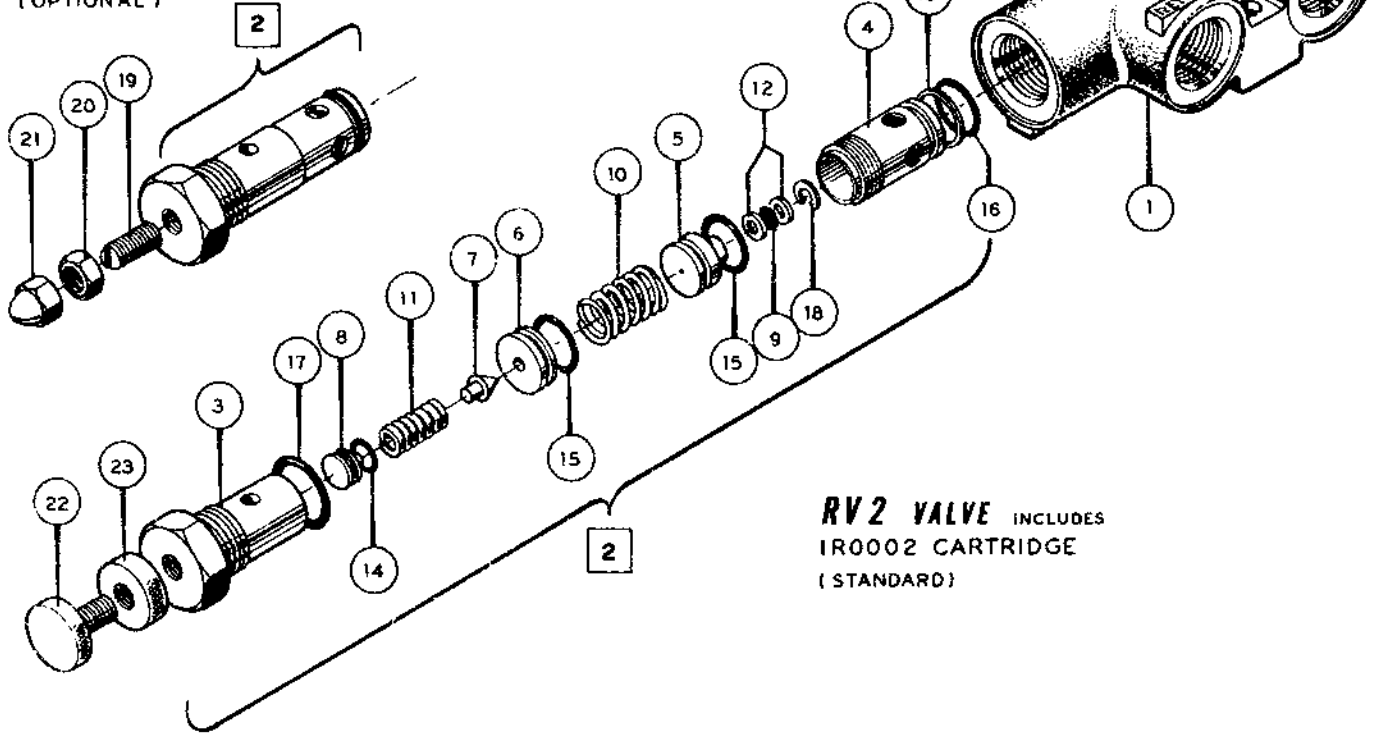

RV2 VALVE INCLUDES
1R0002 CARTRIDGE
(STANDARD)

NEVER ATTEMPT TO ADJUST PRESSURE WITHOUT THE USE OF A RELIABLE GAGE IN THE SYSTEM !

PARTS LIST

○	PART NO.	DESCRIPTION	QTY
RELIEF VALVE HOUSING			
	1R0003	WITH 3/4" NPTF PORTS (OPTIONAL)	1
	1R0004	WITH 7/8"-14 SAE PORTS (OPTIONAL)	1
①	1R0005	WITH 1 1/8"-12 SAE PORTS (STANDARD)	1
②	1R0040	CARTRIDGE ASSEMBLY INCLUDES:	
③	1R0006	CARTRIDGE BODY	1
④	1R0007	POPPET BODY	1
⑤	1R0008	RELIEF POPPET	1
⑥	1R0009	PILOT SEAT	1
⑦	1R0012	PILOT POPPET	1
⑧	1R0013	RELIEF SPRING PISTON	1
⑨	1C1237	SCREEN	1
⑩	1A0563	SPRING	1
⑪	1A0584	PILOT SPRING	1
⑫	1A0588	SPECIAL WASHER	2
⑬	2A0007-018	POPPET BODY BACK-UP	1
⑭	2A0283-7012	PISTON O-RING	1

○	PART NO.	DESCRIPTION	QTY
⑮	2A0283-7016	POPPET O-RING	2
⑯	2A0283-9018	POPPET BODY O-RING	1
⑰	2A0283-9912	BODY O-RING	1
⑱	2A0466-37	RETAINING RING	1
SPECIAL PARTS FOR 1R0001 CARTRIDGE (OPTIONAL)			
⑲	1R0015	ADJUSTMENT SCREW	1
⑳	1A0589	LOCK NUT	1
㉑	1A0570	ACORN NUT	1
SPECIAL PARTS FOR 1R0002 CARTRIDGE (STANDARD)			
㉒	1R0010	ADJUSTMENT SCREW	1
㉓	1R0011	LOCK NUT	1

CROSS MANUFACTURING INC. RESERVES THE RIGHT TO DISCONTINUE PRODUCTS AND/OR TO CHANGE DESIGN, SPECIFICATIONS OR PRICES AT ANY TIME WITHOUT INCURRING ANY OBLIGATION.

SEE FM VRV1 FOR SPECIFICATIONS.